

DEPARTMENT OF TRANSPORT

NO. 255

23 MARCH 2018

**THE SOUTH AFRICAN NATIONAL ROADS
AGENCY SOC LIMITED**

Registration No: 1998/009584/30

DECLARATION AMENDMENT OF NATIONAL ROAD R512 SECTION 3

AMENDMENT OF DECLARATION No. 784 OF 2012.

By virtue of section 40(1)(b) of the South African National Roads Agency Limited and the National Roads Act 1998 (Act No. 7 of 1998), I hereby amend Declaration No. 784 of 2012 by substituting paragraph O of the Schedule, being the descriptive declaration of the route from its junction with Provincial Road R104 up to its junction with National Road R511 Section 3 in Brits, with the accompanying sheets 1 to 5 of Plan No. P964/17.

In the town of Brits the R512 Section 3 enters the town from the South and follows the streets known as Rutgers Road, Harrington Street and Van Deventer Street at the time of declaration.

(National Road R512 Section 3: R104 Junction – Brits)



MINISTER OF TRANSPORT

DEPARTEMENT VAN VERVOER

NO. 255

23 MAART 2018

**DIE SUID-AFRIKAANSE NASIONALE
PADAGENTSKAP MSB BEPERK**

Registrasie No: 1998/009584/30

VERKLARING WYSIGING VAN NASIONALE PAD R512 SEKSIE 3

WYSIGING VAN VERKLARING No. 784 VAN 2012.

Kragtens Artikel 40(1)(b) van die Suid-Afrikaanse Nasionale Padagentskap Beperk en Nasionale Paaie Wet 1998 (Wet No. 7 van 1998), wysig ek hiermee Verklaring No. 784 van 2012 deur paragraaf O van die Skedule te vervang, synde die gedeelte van die beskrywende verklaring van die pad vanaf die aansluiting met Provinsiale Pad R104 tot by vanaf die aansluiting met Nasionale Pad R511 Seksie 3, met bygaande velle 1 tot 5 van Plan No. P964/17.

In die dorp van Brits kom die R512 Seksie 3 die dorp binne vanuit die Suide en volg die strate bekend as Rutgersweg, Harringtonstraat en Van Deventerstraat tydens datum van verklaring.

(Nasionale Pad R512 Seksie 3: R104 Aansluiting – Brits)**MINISTER VAN VERVOER**

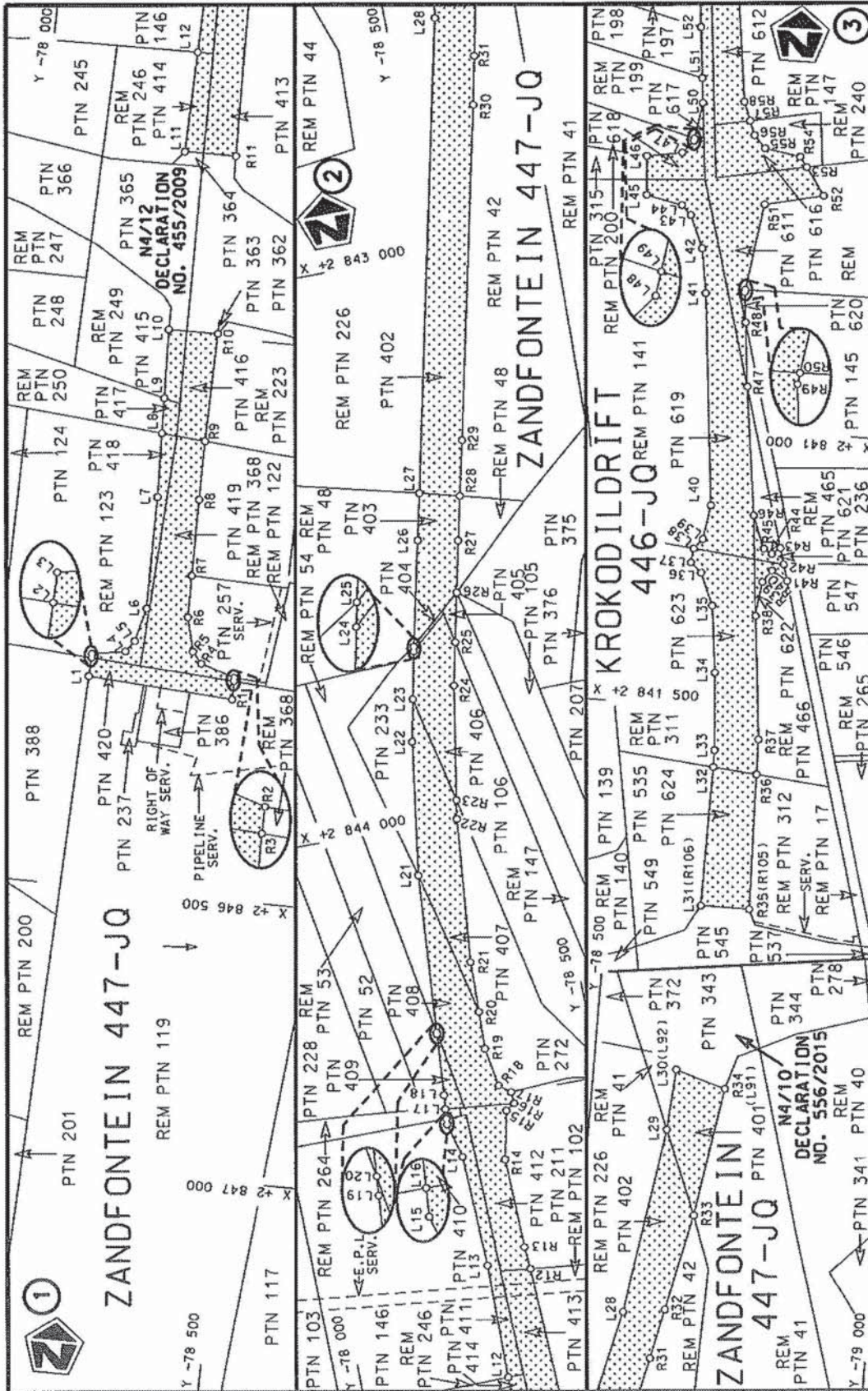

| | | | | |
|---|---|---|----------|---------------------|
| <p>Die Suid Afrikaanse Nasionale Padagentskap MSB Bpk The South African National Roads Agency SOC Ltd</p> | <p>Die figuur getoon The figure shown</p> | <p>stelt die padreserwe voor van 'n gedeelte represents the road reserve of a portion van Nasionale Roete of National Route</p> | <p>3</p> | <p>Plan P964/17</p> |
| | | <p>Vel Sheet 1 of 5</p> | | |

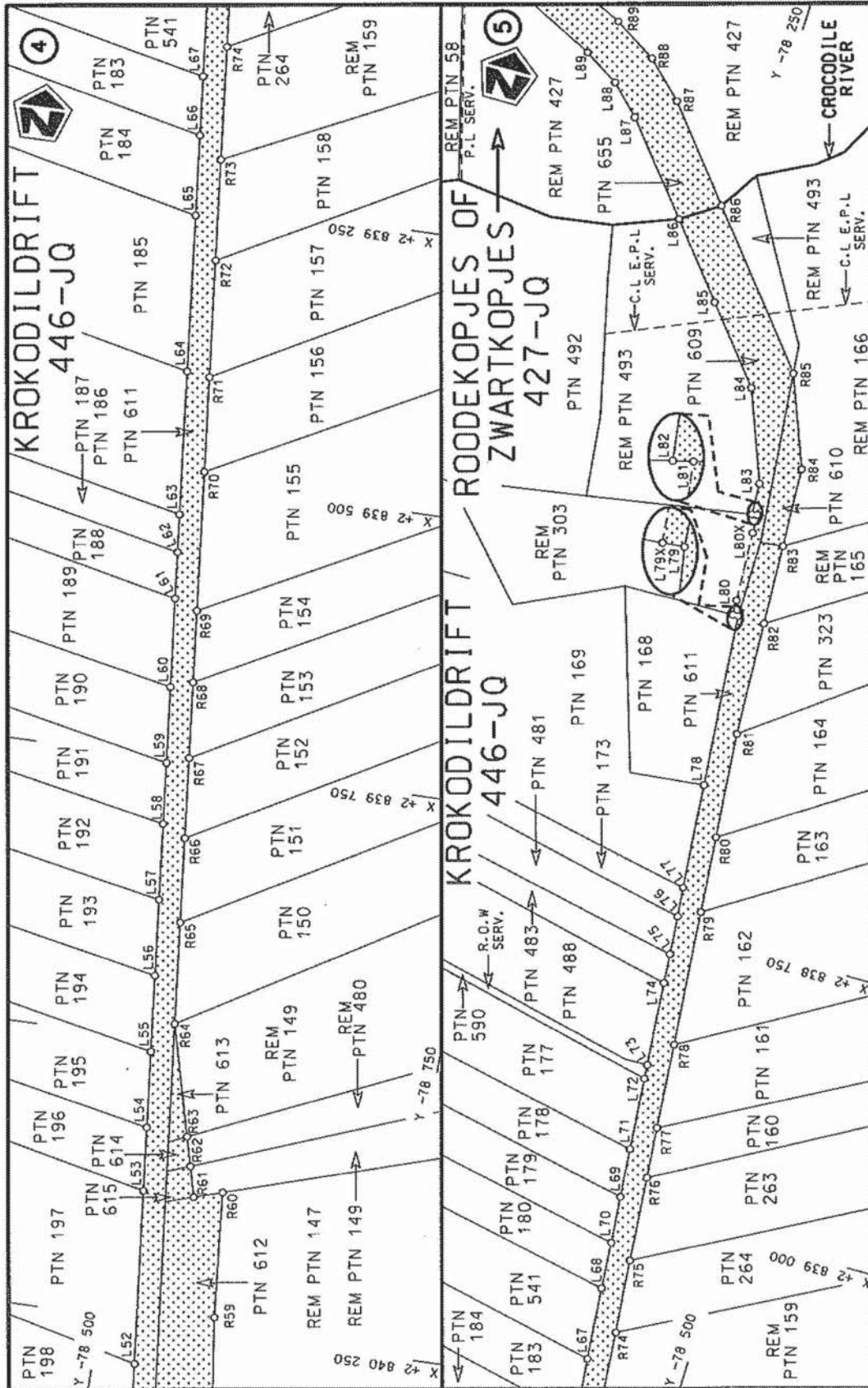

| | | | |
|---|---|--|---------------------------------|
| <p>Die Suid Afrikaanse Nasionale Podagentskap MSB Bpk The South African National Roads Agency SOC Ltd</p> | <p>Die figuur getoon The figure shown</p> | <p>steldie podreserwe voor van 'n gedeelte represents the road reserve of a portion van Nasionale Roete R512 of National Route</p> | <p>Vel van Sheet 2 of 5</p> |
| <p>3</p> | | <p>Seksie Section</p> | <p>Plan P964/17</p> |

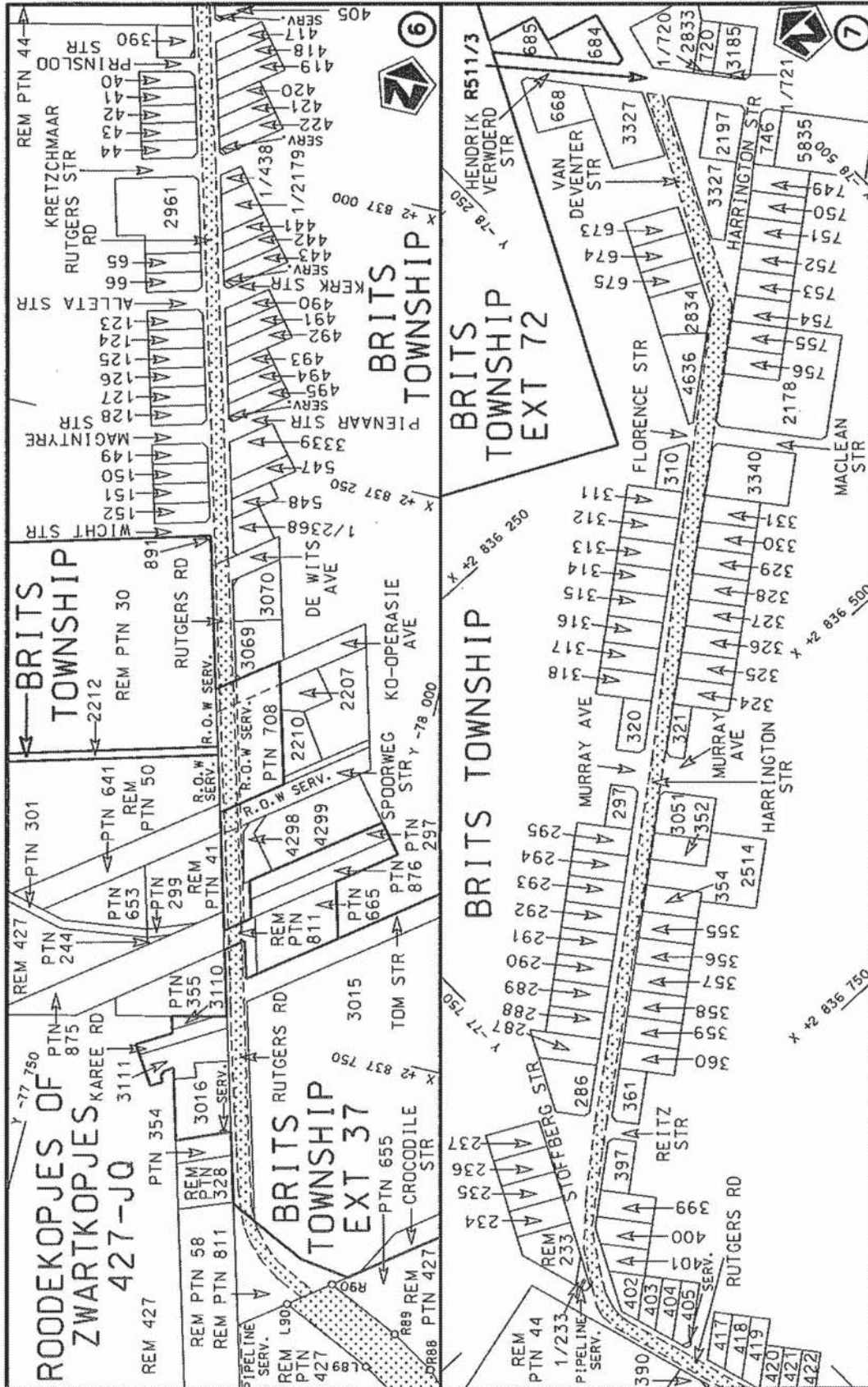

| | | | |
|---|---------------------------------------|--|--------------------------------------|
| Die Suid Afrikaanse Nasionale Padagentskap MSB Bpk The South African National Roads Agency SOC Ltd | Die figuur getoon The figure shown | stelsie podreserwe voor van 'n gedeelte van Nasionale Roete R512 Seksie Section | Vel van Sheet 3 of 5 Plan P964/17 |
|---|---------------------------------------|--|--------------------------------------|

| PADRESERWE KOÖRDINATE / ROAD RESERVE CO-ORDINATES | | | | | | |
|---|------------|-------|--------|----------------------------|------------|--------------|
| LINKERKANT/LEFT HAND SIDE | | | | REGTERKANT/RIGHT HAND SIDE | | |
| | Y | X | WG 27° | | Y | X |
| L1 | -78 180.80 | 2 846 | 125.96 | R1 | -78 427.79 | 2 846 141.97 |
| L2 | -78 181.61 | 2 846 | 092.47 | R2 | -78 427.03 | 2 846 109.34 |
| L3 | -78 181.76 | 2 846 | 085.16 | R3 | -78 427.06 | 2 846 102.85 |
| L4 | -78 238.02 | 2 846 | 075.38 | R4 | -78 368.23 | 2 846 083.42 |
| L5 | -78 251.78 | 2 846 | 055.20 | R5 | -78 351.80 | 2 846 063.57 |
| L6 | -78 265.65 | 2 845 | 995.17 | R6 | -78 336.69 | 2 846 003.78 |
| L7 | -78 262.67 | 2 845 | 795.04 | R7 | -78 335.27 | 2 845 928.84 |
| L8 | -78 257.89 | 2 845 | 680.70 | R8 | -78 333.23 | 2 845 792.38 |
| L9 | -78 255.27 | 2 845 | 618.05 | R9 | -78 332.24 | 2 845 687.24 |
| L10 | -78 250.13 | 2 845 | 495.18 | R10 | -78 333.30 | 2 845 494.15 |
| L11 | -78 243.04 | 2 845 | 175.45 | R11 | -78 330.18 | 2 845 174.55 |
| L12 | -78 245.62 | 2 844 | 996.90 | R12 | -78 319.43 | 2 844 814.24 |
| L13 | -78 248.59 | 2 844 | 794.84 | R13 | -78 316.78 | 2 844 774.35 |
| L14 | -78 244.17 | 2 844 | 596.18 | R14 | -78 314.30 | 2 844 614.37 |
| L15 | -78 229.30 | 2 844 | 534.84 | R15 | -78 332.63 | 2 844 529.45 |
| L16 | -78 230.25 | 2 844 | 524.62 | R16 | -78 348.06 | 2 844 519.02 |
| L17 | -78 231.87 | 2 844 | 507.29 | R17 | -78 346.99 | 2 844 498.29 |
| L18 | -78 234.36 | 2 844 | 481.91 | R18 | -78 328.08 | 2 844 482.50 |
| L19 | -78 243.43 | 2 844 | 373.20 | R19 | -78 317.56 | 2 844 413.98 |
| L20 | -78 243.72 | 2 844 | 369.76 | R20 | -78 320.08 | 2 844 346.91 |
| L21 | -78 267.18 | 2 844 | 088.60 | R21 | -78 322.84 | 2 844 257.32 |
| L22 | -78 301.92 | 2 843 | 851.88 | R22 | -78 348.55 | 2 844 001.88 |
| L23 | -78 317.49 | 2 843 | 777.46 | R23 | -78 354.34 | 2 843 968.10 |
| L24 | -78 335.13 | 2 843 | 693.62 | R24 | -78 388.93 | 2 843 766.38 |
| L25 | -78 336.99 | 2 843 | 685.00 | R25 | -78 405.66 | 2 843 690.51 |
| L26 | -78 379.13 | 2 843 | 499.99 | R26 | -78 424.81 | 2 843 603.38 |
| L27 | -78 397.91 | 2 843 | 417.55 | R27 | -78 444.72 | 2 843 513.29 |
| L28 | -78 583.14 | 2 842 | 587.37 | R28 | -78 462.68 | 2 843 435.07 |
| L29 | -78 632.24 | 2 842 | 257.79 | R29 | -78 484.98 | 2 843 337.85 |
| L30 | -78 640.13 | 2 842 | 149.93 | R30 | -78 616.64 | 2 842 752.47 |
| L31 | -78 658.63 | 2 841 | 854.66 | R31 | -78 634.89 | 2 842 666.52 |
| L32 | -78 660.30 | 2 841 | 606.22 | R32 | -78 653.80 | 2 842 577.90 |
| L33 | -78 660.01 | 2 841 | 576.21 | R33 | -78 689.92 | 2 842 407.10 |
| L34 | -78 649.60 | 2 841 | 437.56 | R34 | -78 724.81 | 2 842 177.88 |
| L35 | -78 635.75 | 2 841 | 318.93 | R35 | -78 740.68 | 2 841 854.94 |
| L36 | -78 612.70 | 2 841 | 261.15 | R36 | -78 734.40 | 2 841 613.89 |
| L37 | -78 593.61 | 2 841 | 244.06 | R37 | -78 732.80 | 2 841 551.13 |
| L38 | -78 596.40 | 2 841 | 218.91 | R38 | -78 710.57 | 2 841 331.47 |
| L39 | -78 610.62 | 2 841 | 201.07 | R39 | -78 718.29 | 2 841 270.31 |
| L40 | -78 619.46 | 2 841 | 139.86 | R40 | -78 732.17 | 2 841 248.79 |
| L41 | -78 581.02 | 2 840 | 761.76 | R41 | -78 758.67 | 2 841 264.87 |
| L42 | -78 568.74 | 2 840 | 682.66 | R42 | -78 750.69 | 2 841 236.04 |
| L43 | -78 545.06 | 2 840 | 624.50 | R43 | -78 742.66 | 2 841 207.02 |
| L44 | -78 528.31 | 2 840 | 607.94 | R44 | -78 729.07 | 2 841 219.14 |
| L45 | -78 467.16 | 2 840 | 594.35 | R45 | -78 715.12 | 2 841 210.51 |
| L46 | -78 462.16 | 2 840 | 524.56 | R46 | -78 693.30 | 2 841 152.21 |
| L47 | -78 521.57 | 2 840 | 514.22 | R47 | -78 664.19 | 2 840 923.51 |
| L48 | -78 539.96 | 2 840 | 491.82 | R48 | -78 652.30 | 2 840 809.77 |
| L49 | -78 540.58 | 2 840 | 487.42 | R49 | -78 646.70 | 2 840 755.13 |
| L50 | -78 549.51 | 2 840 | 423.18 | R50 | -78 647.27 | 2 840 750.88 |
| L51 | -78 544.92 | 2 840 | 378.73 | R51 | -78 667.99 | 2 840 596.48 |

| | | | |
|--------------|---|-----------|---|
| Vel Sheet | 4 | Van of | 5 |
|--------------|---|-----------|---|

P964/17

| PADRESERWE KOÖRDINATE / ROAD RESERVE CO-ORDINATES | | | | | |
|---|------------|-------|----------------------------|-----|-------------------------|
| LINKERKANT/LEFT HAND SIDE | | | REGTERKANT/RIGHT HAND SIDE | | |
| | Y | X | WG 27° | | X |
| L52 | -78 535.60 | 2 840 | 288.49 | R52 | -78 766.67 2 840 573.81 |
| L53 | -78 519.90 | 2 840 | 134.46 | R53 | -78 733.84 2 840 524.85 |
| L54 | -78 514.19 | 2 840 | 078.08 | R54 | -78 721.62 2 840 506.62 |
| L55 | -78 507.18 | 2 840 | 010.42 | R55 | -78 660.66 2 840 496.10 |
| L56 | -78 500.28 | 2 839 | 942.83 | R56 | -78 641.22 2 840 474.06 |
| L57 | -78 493.36 | 2 839 | 875.14 | R57 | -78 631.72 2 840 449.02 |
| L58 | -78 486.46 | 2 839 | 807.53 | R58 | -78 619.21 2 840 415.99 |
| L59 | -78 480.89 | 2 839 | 752.99 | R59 | -78 595.97 2 840 237.43 |
| L60 | -78 473.98 | 2 839 | 685.39 | R60 | -78 586.21 2 840 126.05 |
| L61 | -78 465.74 | 2 839 | 606.42 | R61 | -78 562.48 2 840 133.78 |
| L62 | -78 461.51 | 2 839 | 565.04 | R62 | -78 555.49 2 840 106.84 |
| L63 | -78 458.05 | 2 839 | 531.22 | R63 | -78 548.82 2 840 081.15 |
| L64 | -78 444.99 | 2 839 | 403.44 | R64 | -78 523.28 2 839 982.76 |
| L65 | -78 430.79 | 2 839 | 264.38 | R65 | -78 514.07 2 839 892.66 |
| L66 | -78 423.47 | 2 839 | 192.97 | R66 | -78 506.48 2 839 817.42 |
| L67 | -78 418.00 | 2 839 | 140.33 | R67 | -78 499.12 2 839 746.02 |
| L68 | -78 411.48 | 2 839 | 076.45 | R68 | -78 492.15 2 839 678.43 |
| L69 | -78 407.47 | 2 839 | 035.15 | R69 | -78 485.66 2 839 614.46 |
| L70 | -78 403.28 | 2 838 | 993.78 | R70 | -78 472.94 2 839 490.47 |
| L71 | -78 398.90 | 2 838 | 950.57 | R71 | -78 464.27 2 839 405.87 |
| L72 | -78 392.42 | 2 838 | 886.65 | R72 | -78 453.60 2 839 301.90 |
| L73 | -78 391.14 | 2 838 | 874.31 | R73 | -78 444.35 2 839 211.70 |
| L74 | -78 383.54 | 2 838 | 800.23 | R74 | -78 434.13 2 839 111.10 |
| L75 | -78 380.86 | 2 838 | 773.90 | R75 | -78 427.45 2 839 045.96 |
| L76 | -78 377.37 | 2 838 | 739.96 | R76 | -78 419.80 2 838 971.08 |
| L77 | -78 374.41 | 2 838 | 713.84 | R77 | -78 415.19 2 838 926.01 |
| L78 | -78 364.84 | 2 838 | 620.85 | R78 | -78 407.46 2 838 850.84 |
| L79 | -78 349.07 | 2 838 | 467.74 | R79 | -78 395.09 2 838 730.57 |
| L79X | -78 344.38 | 2 838 | 467.79 | R80 | -78 388.13 2 838 662.93 |
| L80 | -78 343.76 | 2 838 | 454.69 | R81 | -78 378.48 2 838 568.97 |
| L80X | -78 339.63 | 2 838 | 392.93 | R82 | -78 371.96 2 838 467.85 |
| L81 | -78 338.53 | 2 838 | 376.23 | R83 | -78 367.39 2 838 396.93 |
| L82 | -78 334.18 | 2 838 | 376.97 | R84 | -78 362.81 2 838 326.52 |
| L83 | -78 332.37 | 2 838 | 348.92 | R85 | -78 331.47 2 838 246.07 |
| L84 | -78 301.12 | 2 838 | 268.62 | R86 | -78 230.11 2 838 119.48 |
| L85 | -78 249.35 | 2 838 | 203.91 | R87 | -78 166.97 2 838 040.60 |
| L86 | -78 199.04 | 2 838 | 141.10 | R88 | -78 136.10 2 838 009.62 |
| L87 | -78 137.47 | 2 838 | 064.21 | R89 | -78 099.27 2 837 986.01 |
| L88 | -78 112.38 | 2 838 | 039.03 | R90 | -78 037.16 2 837 955.13 |
| L89 | -78 082.45 | 2 838 | 019.84 | | |
| L90 | -78 004.45 | 2 837 | 981.06 | | |

| | | | |
|--------------|---|-----------|---|
| Vel Sheet | 5 | Van of | 5 |
|--------------|---|-----------|---|

P964/17